

Hexagon socket countersunk head screw, fully threaded

SEND THE INQUIRY

+48 58 55 40 410

Standards:

DIN 7991
ISO 10642

4.8

8.8

10.9

Class (standard):

B

WHITE
ZINC
COATING

OX

OXIDATION

S

RAW
PRODUCT

Coating (standard):

A

YELLOW
ZINC
COATING

N

NICKEL
COATING

Coating (special order):

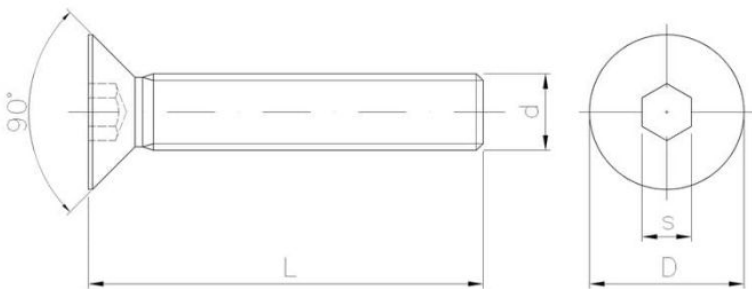
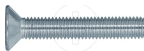
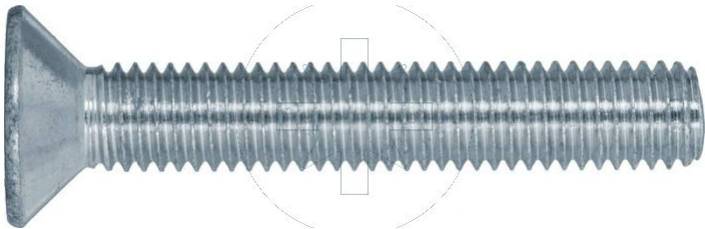

Dimensions

Material index	d	L [mm]	D [mm]	s [mm]	Mechanical properties class	Type of coating	Measure unit
1308040008IMB10T	M4	8	8.0	2.5	10.9	B (White zinc coating)	THS.
1308040008IMO10T	M4	8	8.0	2.5	10.9	OX (oxidation)	THS.
1308040010IMB10T	M4	10	8.0	2.5	10.9	B (White zinc coating)	THS.
1308040010IMO10T	M4	10	8.0	2.5	10.9	OX (oxidation)	THS.
1308040012IMB10T	M4	12	8.0	2.5	10.9	B (White zinc coating)	THS.
1308040012IMO10T	M4	12	8.0	2.5	10.9	OX (oxidation)	THS.
1308040016IMB10T	M4	16	8.0	2.5	10.9	B (White zinc coating)	THS.
1308040020IMB10T	M4	20	8.0	2.5	10.9	B (White zinc coating)	THS.
1308040025IMB10T	M4	25	8.0	2.5	10.9	B (White zinc coating)	THS.
1308050008IMS10T	M5	8	10.0	3.0	10.9	S (raw product)	THS.
1308050010IMB10T	M5	10	10.0	3.0	10.9	B (White zinc coating)	THS.
1308050010IMO10T	M5	10	10.0	3.0	10.9	OX (oxidation)	THS.
1308050012IMB10T	M5	12	10.0	3.0	10.9	B (White zinc coating)	THS.
1308050016IMB10T	M5	16	10.0	3.0	10.9	B (White zinc coating)	THS.
1308050016IMO10T	M5	16	10.0	3.0	10.9	OX (oxidation)	THS.
1308050020IMB10T	M5	20	10.0	3.0	10.9	B (White zinc coating)	THS.
1308050020IMO10T	M5	20	10.0	3.0	10.9	OX (oxidation)	THS.
1308050025IMB10T	M5	30	10.0	3.0	10.9	B (White zinc coating)	THS.

Material index	d	L [mm]	D [mm]	s [mm]	Mechanical properties class	Type of coating	Measure unit
1308050030IMB10T	M5	30	10.0	3.0	10.9	B (White zinc coating)	THS.
1308050030IMO10T	M5	30	10.0	3.0	10.9	OX (oxidation)	THS.
1308050035IMB10T	M5	35	10.0	3.0	10.9	B (White zinc coating)	THS.
1308050040IMB10T	M5	40	10.0	3.0	10.9	B (White zinc coating)	THS.
1308060008IMB10T	M6	8	11.8	4.0	10.9	B (White zinc coating)	THS.
1308060010IMO10T	M6	10	11.8	4.0	10.9	OX (oxidation)	THS.
1308060012IMB10T	M6	12	11.8	4.0	10.9	B (White zinc coating)	THS.
1308060016IMB10T	M6	16	11.8	4.0	10.9	B (White zinc coating)	THS.
1308060016IMBT	M6	16	11.8	4.0	4.8	B (White zinc coating)	THS.
1308060016IMO10T	M6	16	11.8	4.0	10.9	OX (oxidation)	THS.
1308060020IMB10T	M6	20	11.8	4.0	10.9	B (White zinc coating)	THS.
1308060020IMB88T	M6	20	11.8	4.0	8.8	B (White zinc coating)	THS.
1308060020IMBT	M6	20	11.8	4.0	4.8	B (White zinc coating)	THS.
1308060020IMO10T	M6	20	11.8	4.0	10.9	OX (oxidation)	THS.
1308060025IMB10T	M6	25	11.8	4.0	10.9	B (White zinc coating)	THS.
1308060025IMB88T	M6	25	11.8	4.0	8.8	B (White zinc coating)	THS.
1308060025IMBT	M6	25	11.8	4.0	4.8	B (White zinc coating)	THS.
1308060025IMO10T	M6	25	11.8	4.0	10.9	OX (oxidation)	THS.
1308060030IMB10T	M6	30	11.8	4.0	10.9	B (White zinc coating)	THS.
1308060030IMBT	M6	30	11.8	4.0	4.8	B (White zinc coating)	THS.
1308060030IMO10T	M6	30	11.8	4.0	10.9	OX (oxidation)	THS.
1308060035IMB10T	M6	35	11.8	4.0	10.9	B (White zinc coating)	THS.
1308060035IMBT	M6	35	11.8	4.0	4.8	B (White zinc coating)	THS.
1308060040IMB10T	M6	40	11.8	4.0	10.9	B (White zinc coating)	THS.
1308060040IMBT	M6	40	11.8	4.0	4.8	B (White zinc coating)	THS.
1308060040IMO10T	M6	40	11.8	4.0	10.9	OX (oxidation)	THS.
1308060045IMB88T	M6	45	11.8	4.0	8.8	B (White zinc coating)	THS.
1308060050IMB10T	M6	50	11.8	4.0	10.9	B (White zinc coating)	THS.
1308060050IMB88T	M6	50	11.8	4.0	8.8	B (White zinc coating)	THS.
1308060050IMBT	M6	50	11.8	4.0	4.8	B (White zinc coating)	THS.
1308060055IMB10T	M6	55	11.8	4.0	10.9	B (White zinc coating)	THS.
1308060055IMB88T	M6	55	11.8	4.0	8.8	B (White zinc coating)	THS.
1308060060IMB10T	M6	60	11.8	4.0	10.9	B (White zinc coating)	THS.
1308060070IMB10T	M6	70	11.8	4.0	10.9	B (White zinc coating)	THS.
1308060100IMB10T	M6	100	11.8	4.0	10.9	B (White zinc coating)	THS.
1308080010IMB10T	M8	10	16.0	5.0	10.9	B (White zinc coating)	THS.
1308080012IMB10T	M8	12	16.0	5.0	10.9	B (White zinc coating)	THS.
1308080016IMB10T	M8	16	16.0	5.0	10.9	B (White zinc coating)	THS.
1308080020IMB10T	M8	20	16.0	5.0	10.9	B (White zinc coating)	THS.

Material index	d	L [mm]	D [mm]	s [mm]	Mechanical properties class	Type of coating	Measure unit
1308080020IMB88T	M8	20	16.0	5.0	8.8	B (White zinc coating)	THS.
1308080020IMBT	M8	20	16.0	5.0	4.8	B (White zinc coating)	THS.
1308080020IMO10T	M8	20	16.0	5.0	10.9	OX (oxidation)	THS.
1308080025IMB10T	M8	25	16.0	5.0	10.9	B (White zinc coating)	THS.
1308080025IMBT	M8	25	16.0	5.0	4.8	B (White zinc coating)	THS.
1308080025IMC10T	M8	25	16.0	5.0	10.9	C (black zinc coating)	THS.
1308080025IMO10T	M8	25	16.0	5.0	10.9	OX (oxidation)	THS.
1308080030IMB10T	M8	30	16.0	5.0	10.9	B (White zinc coating)	THS.
1308080030IMBT	M8	30	16.0	5.0	4.8	B (White zinc coating)	THS.
1308080030IMO10T	M8	30	16.0	5.0	10.9	OX (oxidation)	THS.
1308080035IMB10T	M8	35	16.0	5.0	10.9	B (White zinc coating)	THS.
1308080035IMO10T	M8	35	16.0	5.0	10.9	OX (oxidation)	THS.
1308080040IMB10T	M8	40	16.0	5.0	10.9	B (White zinc coating)	THS.
1308080040IMO10T	M8	40	16.0	5.0	10.9	OX (oxidation)	THS.
1308080045IMB10T	M8	45	16.0	5.0	10.9	B (White zinc coating)	THS.
1308080050IMB10T	M8	50	16.0	5.0	10.9	B (White zinc coating)	THS.
1308080050IMBT	M8	50	16.0	5.0	4.8	B (White zinc coating)	THS.
1308080060IMB10T	M8	60	16.0	5.0	10.9	B (White zinc coating)	THS.
1308080060IMBT	M8	60	16.0	5.0	4.8	B (White zinc coating)	THS.
1308080070IMBT	M8	70	16.0	5.0	4.8	B (White zinc coating)	THS.
1308100016IMB10T	M10	16	20.0	6.0	10.9	B (White zinc coating)	THS.
1308100020IMB10T	M10	20	20.0	6.0	10.9	B (White zinc coating)	THS.
1308100025IMB10T	M10	25	20.0	6.0	10.9	B (White zinc coating)	THS.
1308100030IMB10T	M10	30	20.0	6.0	10.9	B (White zinc coating)	THS.
1308100035IMB10T	M10	35	20.0	6.0	10.9	B (White zinc coating)	THS.
1308100040IMB10T	M10	40	20.0	6.0	10.9	B (White zinc coating)	THS.
1308100045IMB10T	M10	45	20.0	6.0	10.9	B (White zinc coating)	THS.
1308100050IMB10T	M10	50	20.0	6.0	10.9	B (White zinc coating)	THS.
1308100060IMB10T	M10	60	20.0	6.0	10.9	B (White zinc coating)	THS.
1308100080IMB10T	M10	80	20.0	6.0	10.9	B (White zinc coating)	THS.
1308120020IMB10T	M12	20	24.0	8.0	10.9	B (White zinc coating)	THS.
1308120025IMB10S	M12	25	24.0	8.0	10.9	B (White zinc coating)	PCS.
1308120030IMB10T	M12	30	24.0	8.0	10.9	B (White zinc coating)	THS.
1308120035IMB10S	M12	35	24.0	8.0	10.9	B (White zinc coating)	PCS.
1308120040IMB10S	M12	40	24.0	8.0	10.9	B (White zinc coating)	PCS.
1308120050IMB10S	M12	50	24.0	8.0	10.9	B (White zinc coating)	PCS.
1308160060IMB10S	M16	60	24	8.0	10.9	B (White zinc coating)	PCS.