

SEND THE INQUIRY

+48 58 55 40 410

Standards:

DIN 965
ISO 7046
PN 82208



Class (standard):

4.8

Coating (standard):

B

WHITE
ZINC
COATING

Coating (special order):

A
YELLOW
ZINC
COATING

C
BLACK
ZINC
COATING

N
NICKEL
COATING

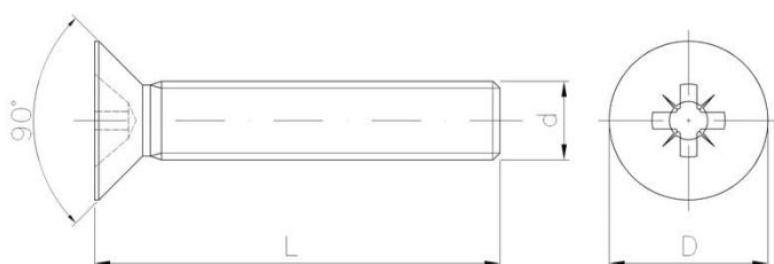

Dimensions

Material index	d	L [mm]	D [mm]	Recess	Mechanical properties class	Type of coating	Measure unit
1306050025PZBT	M5	25	9.2	PZ 2	4.8	B (White zinc coating)	THS.
1306050035PZBK	M5	35	9.2	PZ 2	4.8	B (White zinc coating)	KG
1306050020PZBK	M5	20	9.2	PZ 2	4.8	B (White zinc coating)	KG
1306050016PZBT	M5	16	9.2	PZ 2	4.8	B (White zinc coating)	THS.
1306050010PZBK	M5	10	9.2	PZ 2	4.8	B (White zinc coating)	KG
1306050010PZBT	M5	10	9.2	PZ 2	4.8	B (White zinc coating)	THS.
1306050012PZBT	M5	12	9.2	PZ 2	4.8	B (White zinc coating)	THS.
1306050020PZBT	M5	20	9.2	PZ 2	4.8	B (White zinc coating)	THS.
1306050016PZBK	M5	16	9.2	PZ 2	4.8	B (White zinc coating)	KG
1306050030PZBK	M5	30	9.2	PZ 2	4.8	B (White zinc coating)	KG
1306050045PZBT	M5	45	9.2	PZ 2	4.8	B (White zinc coating)	THS.
1306050025PZBK	M5	25	9.2	PZ 2	4.8	B (White zinc coating)	KG
1306050045PZBK	M5	45	9.2	PZ 2	4.8	B (White zinc coating)	KG
1306050050PZBK	M5	50	9.2	PZ 2	4.8	B (White zinc coating)	KG
1306050030PZBT	M5	30	9.2	PZ 2	4.8	B (White zinc coating)	THS.
1306050040PZBT	M5	40	9.2	PZ 2	4.8	B (White zinc coating)	THS.
1306050035PZBT	M5	35	9.2	PZ 2	4.8	B (White zinc coating)	THS.
1306050012PZBK	M5	12	9.2	PZ 2	4.8	B (White zinc coating)	KG
1306050040PZBK	M5	40	9.2	PZ 2	4.8	B (White zinc coating)	KG

Material index	d	L [mm]	D [mm]	Recess	Mechanical properties class	Type of coating	Measure unit
1306040030PZBT	M4	30	7.5	PZ 2	4.8	B (White zinc coating)	THS.
1306040030PZBK	M4	30	7.5	PZ 2	4.8	B (White zinc coating)	KG
1306040008PZBT	M4	8	7.5	PZ 2	4.8	B (White zinc coating)	THS.
1306040040PZBK	M4	40	7.5	PZ 2	4.8	B (White zinc coating)	KG
1306040025PZBT	M4	25	7.5	PZ 2	4.8	B (White zinc coating)	THS.
1306040016PZBK	M4	16	7.5	PZ 2	4.8	B (White zinc coating)	KG
1306040008PHBT	M4	8	7.5	PH 2	4.8	B (White zinc coating)	THS.
1306040012PZBK	M4	12	7.5	PZ 2	4.8	B (White zinc coating)	KG
1306040025PZBK	M4	25	7.5	PZ 2	4.8	B (White zinc coating)	KG
1306040010PZBK	M4	10	7.5	PZ 2	4.8	B (White zinc coating)	KG
1306040020PZBK	M4	20	7.5	PZ 2	4.8	B (White zinc coating)	KG
1306040020PZBT	M4	20	7.5	PZ 2	4.8	B (White zinc coating)	THS.
1306040040PZBT	M4	40	7.5	PZ 2	4.8	B (White zinc coating)	THS.
1306040006PZBT	M4	6	7.5	PZ 2	4.8	B (White zinc coating)	THS.
1306040012PZBT	M4	12	7.5	PZ 2	4.8	B (White zinc coating)	THS.
1306040010PZBT	M4	10	7.5	PZ 2	4.8	B (White zinc coating)	THS.
1306040016PZBT	M4	16	7.5	PZ 2	4.8	B (White zinc coating)	THS.
1306040022PZBT	M4	22	7.5	PZ 2	4.8	B (White zinc coating)	THS.
1306030008PHBT	M3	8	5.6	PH 1	4.8	B (White zinc coating)	THS.
1306030010PHBT	M3	10	5.6	PH 1	4.8	B (White zinc coating)	THS.
1306030016PHBT	M3	16	5.6	PH 1	4.8	B (White zinc coating)	THS.
1306030008PZBT	M3	8	5.6	PZ 1	4.8	B (White zinc coating)	THS.
1306030006PHBT	M3	6	5.6	PH 1	4.8	B (White zinc coating)	THS.
1306030005PZBT	M3	5	5.6	PZ 1	4.8	B (White zinc coating)	THS.
1306080020PZBK	M8	20	14.5	PZ 4	4.8	B (White zinc coating)	KG
1306080016PZBK	M8	16	14.5	PZ 4	4.8	B (White zinc coating)	KG
1306080040PZBK	M8	40	14.5	PZ 4	4.8	B (White zinc coating)	KG
1306080016PZBT	M8	16	14.5	PZ 4	4.8	B (White zinc coating)	THS.
1306080035PZBT	M8	35	14.5	PZ 4	4.8	B (White zinc coating)	THS.
1306080030PZBT	M8	30	14.5	PZ 4	4.8	B (White zinc coating)	THS.
1306080050PZBT	M8	50	14.5	PZ 4	4.8	B (White zinc coating)	THS.
1306080050PZBK	M8	50	14.5	PZ 4	4.8	B (White zinc coating)	KG
1306080030PZBK	M8	30	14.5	PZ 4	4.8	B (White zinc coating)	KG
1306080025PZBK	M8	25	14.5	PZ 4	4.8	B (White zinc coating)	KG
1306080035PZBK	M8	35	14.5	PZ 4	4.8	B (White zinc coating)	KG
1306080020PZBT	M8	20	14.5	PZ 4	4.8	B (White zinc coating)	THS.
1306080040PZBT	M8	40	14.5	PZ 4	4.8	B (White zinc coating)	THS.
1306080025PZBT	M8	25	14.5	PZ 4	4.8	B (White zinc coating)	THS.
1306060040PZBT	M6	40	11.0	PZ 3	4.8	B (White zinc coating)	THS.

Material index	d	L [mm]	D [mm]	Recess	Mechanical properties class	Type of coating	Measure unit
1306060020PZBT	M6	20	11.0	PZ 3	4.8	B (White zinc coating)	THS.
1306060012PZBT	M6	12	11.0	PZ 3	4.8	B (White zinc coating)	THS.
1306060045PZBK	M6	45	11.0	PZ 3	4.8	B (White zinc coating)	KG
1306060016PZBK	M6	16	11.0	PZ 3	4.8	B (White zinc coating)	KG
1306060020PZBK	M6	20	11.0	PZ 3	4.8	B (White zinc coating)	KG
1306060025PZBK	M6	25	11.0	PZ 3	4.8	B (White zinc coating)	KG
1306060016PZBT	M6	16	11.0	PZ 3	4.8	B (White zinc coating)	THS.
1306060040PZBK	M6	40	11.0	PZ 3	4.8	B (White zinc coating)	KG
1306060030PZBT	M6	30	11.0	PZ 3	4.8	B (White zinc coating)	THS.
1306060055PZBK	M6	55	11.0	PZ 3	4.8	B (White zinc coating)	KG
1306060050PZBK	M6	50	11.0	PZ 3	4.8	B (White zinc coating)	KG
1306060012PZBK	M6	12	11.0	PZ 3	4.8	B (White zinc coating)	KG
1306060050PZBT	M6	50	11.0	PZ 3	4.8	B (White zinc coating)	THS.
1306060060PZBK	M6	60	11.0	PZ 3	4.8	B (White zinc coating)	KG
1306060045PZBT	M6	45	11.0	PZ 3	4.8	B (White zinc coating)	THS.
1306060025PZBT	M6	25	11.0	PZ 3	4.8	B (White zinc coating)	THS.
1306060035PZBK	M6	35	11.0	PZ 3	4.8	B (White zinc coating)	KG
1306060060PZBT	M6	60	11.0	PZ 3	4.8	B (White zinc coating)	THS.
1306060030PZBK	M6	30	11.0	PZ 3	4.8	B (White zinc coating)	KG
1306060035PZBT	M6	35	11.0	PZ 3	4.8	B (White zinc coating)	THS.
1306060010PZBT	M6	10	11.0	PZ 3	4.8	B (White zinc coating)	THS.
1306060016PZCT	M6	16	11.0	PZ 3	4.8	B (White zinc coating)	THS.
1306060025PZCT	M6	25	11.0	PZ 3	4.8	B (White zinc coating)	THS.
1306060020PZCT	M6	20	11.0	PZ 3	4.8	B (White zinc coating)	THS.