

Coating (standard):

**B**

WHITE  
ZINC  
COATING

Coating (special order):

**A**

YELLOW  
ZINC  
COATING

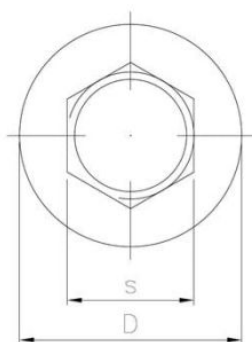
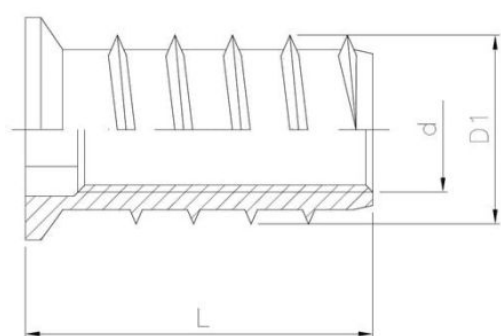

Dimensions

Material index	d	L [mm]	D [mm]	D1 [mm]	s [mm]	Type of coating
1546100150020BT	M10	20	17	15	10	B (White zinc coating)
1546100150025BT	M10	25	17	15	10	B (White zinc coating)
1546080120017BT	M8	17	14	12	8	B (White zinc coating)
1546080120015BT	M8	15	14	12	8	B (White zinc coating)
1546080120020BT	M8	20	14	12	8	B (White zinc coating)
1546080120024BT	M8	24	14	12	8	B (White zinc coating)
1546080120024BMT	M8	24	14	12	8	B (White zinc coating)
1546080120020BMT	M8	20	14	12	8	B (White zinc coating)
1546060100017BT	M6	17	12	10	6	B (White zinc coating)
1546060100020BT	M6	20	12	10	6	B (White zinc coating)
1546060100024BT	M6	24	12	10	6	B (White zinc coating)
1546060100012BT	M6	12	12	10	6	B (White zinc coating)
1546060100013BT	M6	13	12	10	6	B (White zinc coating)
1546060100014BT	M6	14	12	10	6	B (White zinc coating)
1546060100015BT	M6	15	12	10	6	B (White zinc coating)