

SEND THE INQUIRY

+48 58 55 40 410

**Standards:**

ETA-18/0371



Coating (standard):

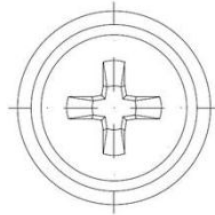
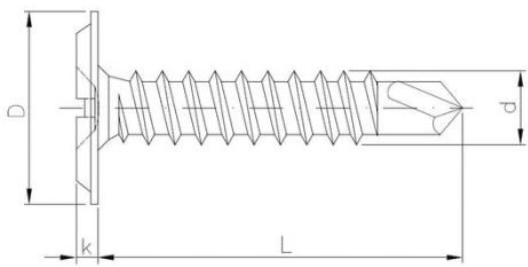
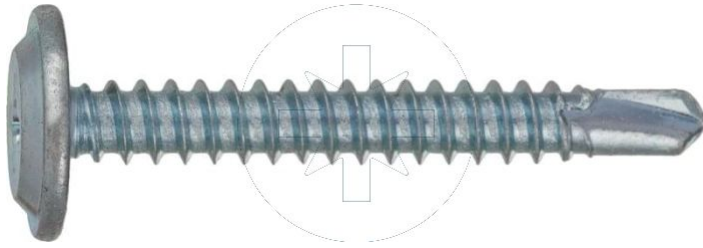

**Dimensions**

Material index	d [mm]	L [mm]	D [mm]	k [mm]	Recess	Type of coating
23160420320PHBWT	4.2	32	11.5	2.3	PH	B (White zinc coating)
23160420190PHBWT	4.2	19	11.5	2.3	PH	B (White zinc coating)
23160420400PHBWT	4.2	40	11.5	2.3	PH	B (White zinc coating)
23160420250PHBWT	4.2	25	11.5	2.3	PH	B (White zinc coating)
23160420160PHBWT	4.2	16	11.5	2.3	PH	B (White zinc coating)
23160420130PHBWT	4.2	13	11.5	2.3	PH	B (White zinc coating)
23160420550PHBWT	4.2	55	11.5	2.3	PH	B (White zinc coating)
23160420160PHCWT	4.2	16	11.5	2.3	PH	C (black zinc coating)
23160420190PHB724T	4.2	19	11.5	2.3	PH	B (White zinc coating)
23160420190PHB910T	4.2	19	11.5	2.3	PH	B (White zinc coating)
23160420160PHB910T	4.2	16	11.5	2.3	PH	B (White zinc coating)
23160420190PHB906T	4.2	19	11.5	2.3	PH	B (White zinc coating)
23160420160PHB716T	4.2	16	11.5	2.3	PH	B (White zinc coating)
23160420190PHB716T	4.2	19	11.5	2.3	PH	B (White zinc coating)
23160420190PHB735T	4.2	19	11.5	2.3	PH	B (White zinc coating)
23160420190PHB905T	4.2	19	11.5	2.3	PH	B (White zinc coating)
23160420160PHB503T	4.2	16	11.5	2.3	PH	B (White zinc coating)
23160420160PHB902T	4.2	16	11.5	2.3	PH	B (White zinc coating)

<b>Material index</b>	<b>d [mm]</b>	<b>L [mm]</b>	<b>D [mm]</b>	<b>k [mm]</b>	<b>Recess</b>	<b>Type of coating</b>
23160420190PHB902T	4.2	19	11.5	2.3	PH	B (White zinc coating)
23160420190PHB503T	4.2	19	11.5	2.3	PH	B (White zinc coating)
23160420160PHB905T	4.2	16	11.5	2.3	PH	B (White zinc coating)
23160420160PHB906T	4.2	16	11.5	2.3	PH	B (White zinc coating)
23160420160PHB735T	4.2	16	11.5	2.3	PH	B (White zinc coating)
23160420160PHB724T	4.2	16	11.5	2.3	PH	B (White zinc coating)