

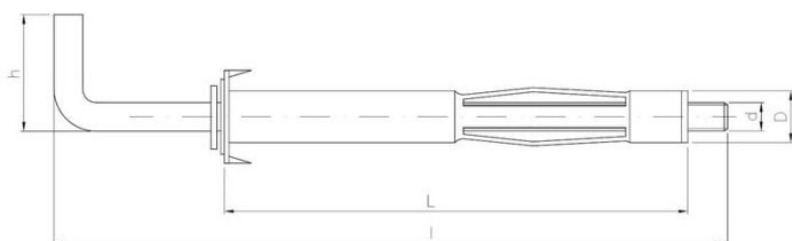

Coating (standard):



WHITE
ZINC
COATING



Dimensions

| Material index | d | L [mm] | D [mm] | l [mm] | h [mm] | Type of coating |
|----------------|----|--------|--------|--------|--------|------------------------|
| 5106050014S | M5 | 51 | 8.8 | 81.5 | 21.0 | B (White zinc coating) |
| 5106040016S | M4 | 39 | 6.5 | 60.0 | 18.5 | B (White zinc coating) |