

SEND THE INQUIRY

+48 58 55 40 410

Standards:

DIN 603
ISO 8677
PN-M 82406

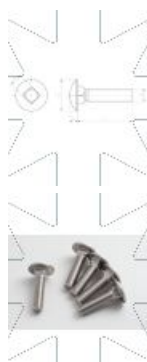
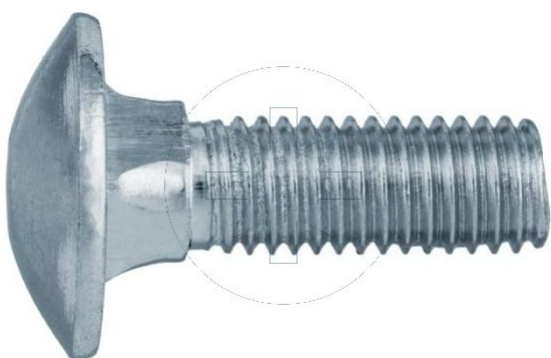

Class (standard):

4.8

Class (special order):

8.8

Coating (standard):

B

WHITE
ZINC
COATING

Coating (special order):

A

YELLOW
ZINC
COATING

S

RAW
PRODUCT

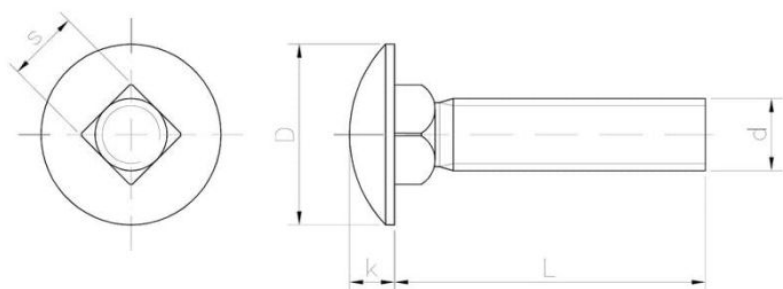

Dimensions

Material index	d	L [mm]	D [mm]	k [mm]	s [mm]	Mechanical properties class	Type of coating	Measure unit
1108080025BD603T	M8	25	20.0	5.0	8.0	4.8	B (White zinc coating)	THS.
1108080025BD603K	M8	25	20.0	5.0	8.0	4.8	B (White zinc coating)	KG
1108080020BD603K	M8	20	20.0	5.0	8.0	4.8	B (White zinc coating)	KG
1108060020BD603K	M6	20	16.0	3.5	6.0	4.8	B (White zinc coating)	KG
1108060016BD603K	M6	16	16.0	3.5	6.0	4.8	B (White zinc coating)	KG
1108060030BD603K	M6	30	16.0	3.5	6.0	4.8	B (White zinc coating)	KG
1108050016BD603K	M5	16	13.0	3.0	5.0	4.8	B (White zinc coating)	KG
1108050030BD603K	M5	30	13.0	3.0	5.0	4.8	B (White zinc coating)	KG
1108050020BD603T	M5	20	13.0	3.0	5.0	4.8	B (White zinc coating)	THS.
1108100025BD603K	M10	25	24.0	6.0	10.0	4.8	B (White zinc coating)	KG
1108100020BD603K	M10	20	24.0	6.0	10.0	4.8	B (White zinc coating)	KG
1108100030BD603K	M10	30	24.0	6.0	10.0	4.8	B (White zinc coating)	KG