

SEND THE INQUIRY

+48 58 55 40 410

Standards:

DIN 931
GOST 7798-70
ISO 4014
PN-M 82101

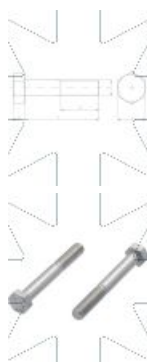
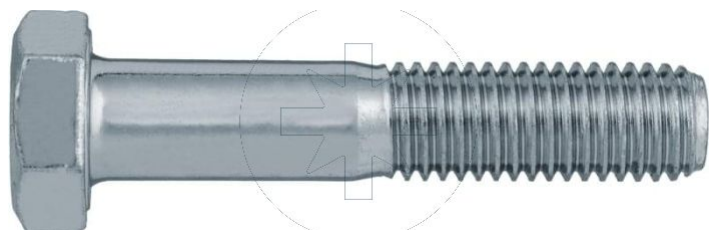

Class (standard):

5.8

8.8

10.9

Class (special order):

12.9

Coating (standard):

B
WHITE
ZINC
COATING

Coating (special order):

A
YELLOW
ZINC
COATING

C
BLACK
ZINC
COATING

G
HDG

N
NICKEL
COATING

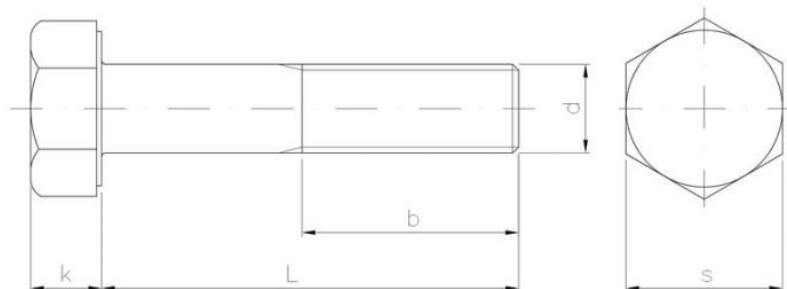

Dimensions

Material index	d	L [mm]	k [mm]	s [mm]	b [mm]	Mechanical properties class	Type of coating	Measure unit
1102300120B88D931S	M30	120	18.7	46.0	66	8.8	B (White zinc coating)	PCS.
1102300200B88D931S	M30	200	18.7	46.0	72	8.8	B (White zinc coating)	PCS.
1102300140B88D931S	M30	140	18.7	46.0	72	8.8	B (White zinc coating)	PCS.
1102240120B58D931K	M24	120	15.0	36.0	54	5.8	B (White zinc coating)	KG
1102240120B88D931S	M24	120	15.0	36.0	54	8.8	B (White zinc coating)	PCS.
1102240100B58D931K	M24	100	15.0	36.0	54	5.8	B (White zinc coating)	KG
1102240140B88D931S	M24	140	15.0	36.0	54	8.8	B (White zinc coating)	PCS.
1102240100B88D931K	M24	100	15.0	36.0	54	8.8	B (White zinc coating)	KG
1102240160B88D931K	M24	160	15.0	36.0	60	8.8	B (White zinc coating)	KG
1102240200B88D931S	M24	200	15.0	36.0	60	8.8	B (White zinc coating)	PCS.
1102240080B88D931S	M24	80	15.0	36.0	54	8.8	B (White zinc coating)	PCS.
1102240120B88D931K	M24	120	15.0	36.0	54	8.8	B (White zinc coating)	KG
1102240100B88D931S	M24	100	15.0	36.0	54	8.8	B (White zinc coating)	PCS.
1102240090B88D931K	M24	90	15.0	36.0	54	8.8	B (White zinc coating)	KG
1102240100S10D931S	M24	100	15.0	36.0	54	10.9	S (raw product)	PCS.
1102240180B88D931S	M24	180	15.0	36.0	60	8.8	B (White zinc coating)	PCS.

Material index	d	L [mm]	k [mm]	s [mm]	b [mm]	Mechanical properties class	Type of coating	Measure unit
1102240200S10D931S	M24	200	15.0	36.0	60	10.9	S (raw product)	PCS.
1102240140S10D931S	M24	140	15.0	36.0	60	10.9	S (raw product)	PCS.
1102240120S10D931S	M24	120	15.0	36.0	54	10.9	S (raw product)	PCS.
1102240110B88D931S	M24	110	15.0	36.0	54	8.8	B (White zinc coating)	PCS.
1102240110B58D931K	M24	110	15.0	36.0	54	5.8	B (White zinc coating)	KG
1102200100S10D931S	M20	100	12.5	30.0	42	10.9	S (raw product)	PCS.
1102200080B88D931K	M20	80	12.5	30.0	42	8.8	B (White zinc coating)	KG
1102200120B58D931K	M20	120	12.5	30.0	42	5.8	B (White zinc coating)	KG
1102200180B58D931K	M20	180	12.5	30.0	48	5.8	B (White zinc coating)	KG
1102200070B88D931S	M20	70	12.5	30.0	42	8.8	B (White zinc coating)	PCS.
1102200060B58D931K	M20	60	12.5	30.0	42	5.8	B (White zinc coating)	KG
1102200160B58D931K	M20	160	12.5	30.0	48	5.8	B (White zinc coating)	KG
1102200220B58D931K	M20	220	12.5	30.0	48	5.8	B (White zinc coating)	KG
1102200180B88D931S	M20	180	12.5	30.0	48	8.8	B (White zinc coating)	PCS.
1102200120S10D931S	M20	120	12.5	30.0	42	10.9	S (raw product)	PCS.
1102200140B88D931S	M20	140	12.5	30.0	48	8.8	B (White zinc coating)	PCS.
1102200080B88D931S	M20	80	12.5	30.0	42	8.8	B (White zinc coating)	PCS.
1102200070S10D931S	M20	70	12.5	30.0	42	10.9	S (raw product)	PCS.
1102200100B58D931K	M20	100	12.5	30.0	42	5.8	B (White zinc coating)	KG
1102200150B88D931S	M20	150	12.5	30.0	48	8.8	B (White zinc coating)	PCS.
1102200140B88D931K	M20	140	12.5	30.0	48	8.8	B (White zinc coating)	KG
1102200090B88D931K	M20	90	12.5	30.0	42	8.8	B (White zinc coating)	KG
1102200070B58D931K	M20	70	12.5	30.0	42	5.8	B (White zinc coating)	KG
1102200120B88D931K	M20	120	12.5	30.0	42	8.8	B (White zinc coating)	KG
1102200080B58D931K	M20	80	12.5	30.0	42	5.8	B (White zinc coating)	KG
1102200140S10D931S	M20	140	12.5	30.0	48	10.9	S (raw product)	PCS.
1102200160B88D931S	M20	160	12.5	30.0	48	8.8	B (White zinc coating)	PCS.
1102200240B58D931K	M20	240	12.5	30.0	48	5.8	B (White zinc coating)	KG
1102200160S10D931S	M20	160	12.5	30.0	48	10.9	B (White zinc coating)	PCS.
1102200070B88D931K	M20	70	12.5	30.0	42	8.8	B (White zinc coating)	KG
1102200200B88D931S	M20	200	12.5	30.0	48	8.8	B (White zinc coating)	PCS.
1102200060S10D931S	M20	60	12.5	30.0	42	10.9	S (raw product)	PCS.
1102200130B88D931S	M20	130	12.5	30.0	48	8.8	B (White zinc coating)	PCS.
1102200060B88D931K	M20	60	12.5	30.0	42	8.8	B (White zinc coating)	KG
1102200080S10D931S	M20	80	12.5	30.0	42	10.9	S (raw product)	PCS.
1102200140B58D931K	M20	140	12.5	30.0	48	5.8	B (White zinc coating)	KG
1102200170B58D931K	M20	170	12.5	30.0	48	5.8	B (White zinc coating)	KG
1102200180B88D931K	M20	180	12.5	30.0	48	8.8	B (White zinc coating)	KG
1102200110B88D931K	M20	110	12.5	30.0	42	8.8	B (White zinc coating)	KG

Material index	d	L [mm]	k [mm]	s [mm]	b [mm]	Mechanical properties class	Type of coating	Measure unit
1102200200S10D931S	M20	200	12.5	30.0	48	10.9	S (raw product)	PCS.
1102200200B58D931K	M20	200	12.5	30.0	48	5.8	B (White zinc coating)	KG
1102200090B58D931K	M20	90	12.5	30.0	42	5.8	B (White zinc coating)	KG
1102200100B88D931K	M20	100	12.5	30.0	42	8.8	B (White zinc coating)	KG
1102200150B58D931K	M20	150	12.5	30.0	48	5.8	B (White zinc coating)	KG
1102200110B58D931K	M20	110	12.5	30.0	42	5.8	B (White zinc coating)	KG
1102200130B58D931K	M20	130	12.5	30.0	48	5.8	B (White zinc coating)	KG
1102200180S10D931S	M20	180	12.5	30.0	48	10.9	S (raw product)	PCS.
1102200075B88D931K	M20	75	12.5	30.0	42	8.8	B (White zinc coating)	KG
1102200090S10D931S	M20	90	12.5	30.0	42	10.9	S (raw product)	PCS.
1102180160B88D931S	M18	160	12.0	27.0	48	8.8	B (White zinc coating)	PCS.
1102180100B88D931S	M18	100	12.0	27.0	42	8.8	B (White zinc coating)	PCS.
1102180160S10D931S	M18	160	12.0	27.0	48	10.9	S (raw product)	PCS.
1102180080B88D931S	M18	80	12.0	27.0	42	8.8	B (White zinc coating)	PCS.
1102180070B88D931S	M18	70	12.0	27.0	42	8.8	B (White zinc coating)	PCS.
1102180120S10D931S	M18	120	12.0	27.0	42	10.9	S (raw product)	PCS.
1102180140B88D931S	M18	140	12.0	27.0	48	8.8	B (White zinc coating)	PCS.
1102180100S10D931S	M18	100	12.0	27.0	42	10.9	S (raw product)	PCS.
1102180090B88D931S	M18	90	12.0	27.0	42	8.8	B (White zinc coating)	PCS.
1102180140S10D931S	M18	140	12.0	27.0	48	10.9	S (raw product)	PCS.
1102180080S10D931S	M18	80	12.0	27.0	42	10.9	S (raw product)	PCS.
1102180060S10D931S	M18	60	12.0	27.0	42	10.9	S (raw product)	PCS.
1102160130B88D931S	M16	130	10.0	24.0	44	8.8	B (White zinc coating)	PCS.
1102160090B58D931K	M16	90	10.0	24.0	38	5.8	B (White zinc coating)	KG
1102160065B88D931K	M16	65	10.0	24.0	38	8.8	B (White zinc coating)	KG
1102160055B58D931K	M16	55	10.0	24.0	38	5.8	B (White zinc coating)	KG
1102160140B88D931K	M16	140	10.0	24.0	44	8.8	B (White zinc coating)	KG
1102160100B88D931K	M16	100	10.0	24.0	38	8.8	B (White zinc coating)	KG
1102160060S10D931S	M16	60	10.0	24.0	38	10.9	S (raw product)	PCS.
1102160050S10D931S	M16	50	10.0	24.0	38	10.9	S (raw product)	PCS.
1102160080B58D931K	M16	80	10.0	24.0	38	5.8	B (White zinc coating)	KG
1102160070S10D931S	M16	70	10.0	24.0	38	10.9	S (raw product)	PCS.
1102160060B58D931K	M16	60	10.0	24.0	38	5.8	B (White zinc coating)	KG
1102160140B58D931K	M16	140	10.0	24.0	44	5.8	B (White zinc coating)	KG
1102160055B88D931K	M16	55	10.0	24.0	38	8.8	B (White zinc coating)	KG
1102160200B58D931K	M16	200	10.0	24.0	44	5.8	B (White zinc coating)	KG
1102160140S10D931S	M16	140	10.0	24.0	44	10.9	S (raw product)	PCS.
1102160130B88D931K	M16	130	10.0	24.0	44	8.8	B (White zinc coating)	KG
1102160050B58D931K	M16	50	10.0	24.0	38	5.8	B (White zinc coating)	KG

Material index	d	L [mm]	k [mm]	s [mm]	b [mm]	Mechanical properties class	Type of coating	Measure unit
1102160080B88D931K	M16	80	10.0	24.0	38	8.8	B (White zinc coating)	KG
1102160130B58D931K	M16	130	10.0	24.0	44	5.8	B (White zinc coating)	KG
1102160150B58D931K	M16	150	10.0	24.0	44	5.8	B (White zinc coating)	KG
1102160180B58D931K	M16	180	10.0	24.0	44	5.8	B (White zinc coating)	KG
1102160120B88D931K	M16	120	10.0	24.0	38	8.8	B (White zinc coating)	KG
1102160120S10D931S	M16	120	10.0	24.0	38	10.9	S (raw product)	PCS.
1102160060B88D931K	M16	60	10.0	24.0	38	8.8	B (White zinc coating)	KG
1102160180S10D931S	M16	180	10.0	24.0	44	10.9	S (raw product)	PCS.
1102160150B88D931K	M16	150	10.0	24.0	44	8.8	B (White zinc coating)	KG
1102160120B58D931K	M16	120	10.0	24.0	38	5.8	B (White zinc coating)	KG
1102160150B88D931S	M16	150	10.0	24.0	44	8.8	B (White zinc coating)	PCS.
1102160120B88D931S	M16	120	10.0	24.0	38	8.8	B (White zinc coating)	PCS.
1102160060B88D931T	M16	60	10.0	24.0	38	8.8	B (White zinc coating)	THS.
1102160070B88D931K	M16	70	10.0	24.0	38	8.8	B (White zinc coating)	KG
1102160070B88D931T	M16	70	10.0	24.0	38	8.8	B (White zinc coating)	THS.
1102160160S10D931S	M16	160	10.0	24.0	44	10.9	S (raw product)	PCS.
1102160100B88D931T	M16	100	10.0	24.0	38	8.8	B (White zinc coating)	THS.
1102160200B88D931S	M16	200	10.0	24.0	44	8.8	B (White zinc coating)	PCS.
1102160160B88D931S	M16	160	10.0	24.0	44	8.8	B (White zinc coating)	PCS.
1102160080B88D931T	M16	80	10.0	24.0	38	8.8	B (White zinc coating)	THS.
1102160180B88D931K	M16	180	10.0	24.0	44	8.8	B (White zinc coating)	KG
1102160070B58D931K	M16	70	10.0	24.0	38	5.8	B (White zinc coating)	KG
1102160050B88D931K	M16	50	10.0	24.0	38	8.8	B (White zinc coating)	KG
1102160050B88D931T	M16	50	10.0	24.0	38	8.8	B (White zinc coating)	THS.
1102160160B58D931K	M16	160	10.0	24.0	44	5.8	B (White zinc coating)	KG
1102160220B88D931S	M16	220	10.0	24.0	44	8.8	B (White zinc coating)	PCS.
1102160090B88D931K	M16	90	10.0	24.0	38	8.8	B (White zinc coating)	KG
1102160080S10D931S	M16	80	10.0	24.0	38	10.9	S (raw product)	PCS.
1102160160B88D931K	M16	160	10.0	24.0	44	8.8	B (White zinc coating)	KG
1102160110B88D931K	M16	110	10.0	24.0	38	8.8	B (White zinc coating)	KG
1102160240B88D931S	M16	240	10.0	24.0	44	8.8	B (White zinc coating)	PCS.
1102160090S10D931S	M16	90	10.0	24.0	38	10.9	S (raw product)	PCS.
1102160100B58D931K	M16	100	10.0	24.0	38	5.8	B (White zinc coating)	KG
1102160200S10D931S	M16	200	10.0	24.0	44	10.9	S (raw product)	PCS.
1102160110B58D931K	M16	110	10.0	24.0	38	5.8	B (White zinc coating)	KG
1102160140B88D931S	M16	140	10.0	24.0	44	8.8	B (White zinc coating)	PCS.
1102160100S10D931S	M16	100	10.0	24.0	38	10.9	S (raw product)	PCS.
1102140160S10D931S	M14	160	9.0	22.0	40	10.9	S (raw product)	PCS.
1102140080B88D931K	M14	80	9.0	22.0	34	8.8	B (White zinc coating)	KG

Material index	d	L [mm]	k [mm]	s [mm]	b [mm]	Mechanical properties class	Type of coating	Measure unit
1102140070S10D931S	M14	70	9.0	22.0	34	10.9	S (raw product)	PCS.
1102140060B88D931K	M14	60	9.0	22.0	34	8.8	B (White zinc coating)	KG
1102140100S10D931S	M14	100	9.0	22.0	34	10.9	S (raw product)	PCS.
1102140060S10D931S	M14	60	9.0	22.0	34	10.9	S (raw product)	PCS.
1102140120B88D931S	M14	120	9.0	22.0	40	8.8	B (White zinc coating)	PCS.
1102140100B58D931K	M14	100	9.0	22.0	34	5.8	B (White zinc coating)	KG
1102140100B88D931K	M14	100	9.0	22.0	34	8.8	B (White zinc coating)	KG
1102140080S10D931S	M14	80	9.0	22.0	34	10.9	S (raw product)	PCS.
1102140090B88D931K	M14	90	9.0	22.0	34	8.8	B (White zinc coating)	KG
1102140080B58D931K	M14	80	9.0	22.0	34	5.8	B (White zinc coating)	KG
1102140140B88D931K	M14	140	9.0	22.0	40	8.8	B (White zinc coating)	KG
1102140180S10D931S	M14	180	9.0	22.0	40	10.9	S (raw product)	PCS.
1102140050B88D931K	M14	50	9.0	22.0	34	8.8	B (White zinc coating)	KG
1102140140S10D931S	M14	140	9.0	22.0	40	10.9	S (raw product)	PCS.
1102140120S10D931S	M14	120	9.0	22.0	40	10.9	S (raw product)	PCS.
1102140050S10D931S	M14	50	9.0	22.0	34	10.9	S (raw product)	PCS.
1102120180B88D931S	M12	180	7.5	19.0	36	8.8	B (White zinc coating)	PCS.
1102120200S10D931S	M12	200	7.5	19.0	36	10.9	S (raw product)	PCS.
1102120090B58D931K	M12	90	7.5	19.0	30	5.8	B (White zinc coating)	KG
1102120080B88D931K	M12	80	7.5	19.0	30	8.8	B (White zinc coating)	KG
1102120150B58D931K	M12	150	7.5	19.0	36	5.8	B (White zinc coating)	KG
1102120200B58D931K	M12	200	7.5	19.0	36	5.8	B (White zinc coating)	KG
1102120160S10D931S	M12	160	7.5	19.0	36	10.9	S (raw product)	PCS.
1102120120B58D931K	M12	120	7.5	19.0	30	5.8	B (White zinc coating)	KG
1102120080B58D931K	M12	80	7.5	19.0	30	5.8	B (White zinc coating)	KG
1102120100B58D931K	M12	100	7.5	19.0	30	5.8	B (White zinc coating)	KG
1102120080B88D931T	M12	80	7.5	19.0	30	8.8	B (White zinc coating)	THS.
1102120180B58D931K	M12	180	7.5	19.0	36	5.8	B (White zinc coating)	KG
1102120070B88D931K	M12	70	7.5	19.0	30	8.8	B (White zinc coating)	KG
1102120065B88D931K	M12	65	7.5	19.0	30	8.8	B (White zinc coating)	KG
1102120130B88D931K	M12	130	7.5	19.0	36	8.8	B (White zinc coating)	KG
1102120045B88D931K	M12	45	7.5	19.0	30	8.8	B (White zinc coating)	KG
1102120140S10D931S	M12	140	7.5	19.0	36	10.9	S (raw product)	PCS.
1102120110B88D931K	M12	110	7.5	19.0	30	8.8	B (White zinc coating)	KG
1102120090B88D931K	M12	90	7.5	19.0	30	8.8	B (White zinc coating)	KG
1102120120B88D931T	M12	120	7.5	19.0	30	8.8	B (White zinc coating)	THS.
1102120060B88D931K	M12	60	7.5	19.0	30	8.8	B (White zinc coating)	KG
1102120060S10D931S	M12	60	7.5	19.0	30	10.9	S (raw product)	PCS.
1102120120S10D931S	M12	120	7.5	19.0	30	10.9	S (raw product)	PCS.

Material index	d	L [mm]	k [mm]	s [mm]	b [mm]	Mechanical properties class	Type of coating	Measure unit
1102120070B58D931K	M12	70	7.5	19.0	30	5.8	B (White zinc coating)	KG
1102120130B58D931K	M12	130	7.5	19.0	36	5.8	B (White zinc coating)	KG
1102120140B88D931K	M12	140	7.5	19.0	36	8.8	B (White zinc coating)	KG
1102120060B58D931K	M12	60	7.5	19.0	30	5.8	B (White zinc coating)	KG
1102120160B88D931S	M12	160	7.5	19.0	36	8.8	B (White zinc coating)	PCS.
1102120050B88D931K	M12	50	7.5	19.0	30	8.8	B (White zinc coating)	KG
1102120160B88D931K	M12	160	7.5	19.0	36	8.8	B (White zinc coating)	KG
1102120050B58D931K	M12	50	7.5	19.0	30	5.8	B (White zinc coating)	KG
1102120160B58D931K	M12	160	7.5	19.0	36	5.8	B (White zinc coating)	KG
1102120055B88D931T	M12	55	7.5	19.0	30	8.8	B (White zinc coating)	THS.
1102120200B88D931S	M12	200	7.5	19.0	36	8.8	B (White zinc coating)	PCS.
1102120080S10D931S	M12	80	7.5	19.0	30	10.9	S (raw product)	PCS.
1102120050S10D931S	M12	50	7.5	19.0	30	10.9	S (raw product)	PCS.
1102120120B88D931K	M12	120	7.5	19.0	30	8.8	B (White zinc coating)	KG
1102120150B88D931K	M12	150	7.5	19.0	36	8.8	B (White zinc coating)	KG
1102120180B88D931K	M12	180	7.5	19.0	36	8.8	B (White zinc coating)	KG
1102120180S10D931S	M12	180	7.5	19.0	36	10.9	S (raw product)	PCS.
1102120100B88D931K	M12	100	7.5	19.0	30	8.8	B (White zinc coating)	KG
1102120040B10D931T	M12	40	7.5	19.0	30	10.9	B (White zinc coating)	THS.
1102120140B88D931S	M12	140	7.5	19.0	36	8.8	B (White zinc coating)	PCS.
1102120100S10D931S	M12	100	7.5	19.0	30	10.9	S (raw product)	PCS.
1102120070S10D931S	M12	70	7.5	19.0	30	10.9	S (raw product)	PCS.
1102120140B58D931K	M12	140	7.5	19.0	36	5.8	B (White zinc coating)	KG
1102120110B58D931K	M12	110	7.5	19.0	30	5.8	B (White zinc coating)	KG
1102120100B88D931T	M12	100	7.5	19.0	30	8.8	B (White zinc coating)	THS.
1102120075B58D931K	M12	75	7.5	19.0	30	5.8	B (White zinc coating)	KG
1102120090S10D931S	M12	90	7.5	19.0	30	10.9	S (raw product)	PCS.
1102120040S10D931T	M12	40	7.5	19.0	30	10.9	S (raw product)	THS.
1102100050B88D931K	M10	50	6.4	17.0	26	8.8	B (White zinc coating)	KG
1102100160S10D931S	M10	160	6.4	17.0	32	10.9	S (raw product)	PCS.
1102100130B88D931K	M10	130	6.4	17.0	32	8.8	B (White zinc coating)	KG
1102100050B58D931K	M10	50	6.4	17.0	26	5.8	B (White zinc coating)	KG
1102100060B58D931K	M10	60	6.4	17.0	26	5.8	B (White zinc coating)	KG
1102100100B58D931K	M10	100	6.4	17.0	26	5.8	B (White zinc coating)	KG
1102100160B88D931K	M10	160	6.4	17.0	32	8.8	B (White zinc coating)	KG
1102100040B88D931K	M10	40	6.4	17.0	26	8.8	B (White zinc coating)	KG
1102100120B88D931T	M10	120	6.4	17.0	26	8.8	B (White zinc coating)	THS.
1102100140B58D931K	M10	140	6.4	17.0	32	5.8	B (White zinc coating)	KG
1102100140B88D931K	M10	140	6.4	17.0	32	8.8	B (White zinc coating)	KG

Material index	d	L [mm]	k [mm]	s [mm]	b [mm]	Mechanical properties class	Type of coating	Measure unit
1102100060B88D931K	M10	60	6.4	17.0	26	8.8	B (White zinc coating)	KG
1102100100B88D931K	M10	100	6.4	17.0	26	8.8	B (White zinc coating)	KG
1102100120B88D931K	M10	120	6.4	17.0	26	8.8	B (White zinc coating)	KG
1102100170B88D931K	M10	170	6.4	17.0	32	8.8	B (White zinc coating)	KG
1102100150B88D931S	M10	150	6.4	17.0	32	8.8	B (White zinc coating)	PCS.
1102100130B58D931K	M10	130	6.4	17.0	32	5.8	B (White zinc coating)	KG
1102100070B58D931K	M10	70	6.4	17.0	26	5.8	B (White zinc coating)	KG
1102100090B88D931K	M10	90	6.4	17.0	26	8.8	B (White zinc coating)	KG
1102100120B58D931K	M10	120	6.4	17.0	26	5.8	B (White zinc coating)	KG
1102100070B88D931K	M10	70	6.4	17.0	26	8.8	B (White zinc coating)	KG
1102100120S10D931T	M10	120	6.4	17.0	26	10.9	S (raw product)	THS.
1102100150B58D931K	M10	150	6.4	17.0	32	5.8	B (White zinc coating)	KG
1102100110B88D931K	M10	110	6.4	17.0	26	8.8	B (White zinc coating)	KG
1102100060S10D931S	M10	60	6.4	17.0	26	10.9	S (raw product)	PCS.
1102100180S10D931S	M10	180	6.4	17.0	32	10.9	S (raw product)	PCS.
1102100110B58D931K	M10	110	6.4	17.0	26	5.8	B (White zinc coating)	KG
1102100080B58D931K	M10	80	6.4	17.0	26	5.8	B (White zinc coating)	KG
1102100100B88D931T	M10	100	6.4	17.0	26	8.8	B (White zinc coating)	THS.
1102100100S10D931T	M10	100	6.4	17.0	26	10.9	S (raw product)	THS.
1102100160B58D931K	M10	160	6.4	17.0	32	5.8	B (White zinc coating)	KG
1102100090B58D931K	M10	90	6.4	17.0	26	5.8	B (White zinc coating)	KG
1102100090S10D931T	M10	90	6.4	17.0	26	10.9	S (raw product)	THS.
1102100180B88D931S	M10	180	6.4	17.0	32	8.8	B (White zinc coating)	PCS.
1102100080B88D931K	M10	80	6.4	17.0	26	8.8	B (White zinc coating)	KG
1102100200B88D931S	M10	200	6.4	17.0	32	8.8	B (White zinc coating)	PCS.
1102100140S10D931S	M10	140	6.4	17.0	32	10.9	S (raw product)	PCS.
1102100140B88D931S	M10	140	6.4	17.0	32	8.8	B (White zinc coating)	PCS.
1102100130B88D931S	M10	130	6.4	17.0	32	8.8	B (White zinc coating)	PCS.
1102100040S10D931T	M10	40	6.4	17.0	26	10.9	S (raw product)	THS.
1102100050S10D931T	M10	50	6.4	17.0	26	10.9	S (raw product)	THS.
1102100070S10D931T	M10	70	6.4	17.0	26	10.9	S (raw product)	THS.
1102100080S10D931T	M10	80	6.4	17.0	26	10.9	S (raw product)	THS.
1102080080S10D931T	M8	80	5.3	13.0	22	10.9	S (raw product)	THS.
1102080060B58D931K	M8	60	5.3	13.0	22	5.8	B (White zinc coating)	KG
1102080065B58D931K	M8	65	5.3	13.0	22	5.8	B (White zinc coating)	KG
1102080100B58D931K	M8	100	5.3	13.0	22	5.8	B (White zinc coating)	KG
1102080130B58D931K	M8	130	5.3	13.0	22	5.8	B (White zinc coating)	KG
1102080100B88D931K	M8	100	5.3	13.0	22	8.8	B (White zinc coating)	KG
1102080050B88D931K	M8	50	5.3	13.0	22	8.8	B (White zinc coating)	KG

Material index	d	L [mm]	k [mm]	s [mm]	b [mm]	Mechanical properties class	Type of coating	Measure unit
1102080150B58D931K	M8	150	5.3	13.0	22	5.8	B (White zinc coating)	KG
1102080050B58D931K	M8	50	5.3	13.0	22	5.8	B (White zinc coating)	KG
1102080060B88D931K	M8	60	5.3	13.0	22	8.8	B (White zinc coating)	KG
1102080040B88D931K	M8	40	5.3	13.0	22	8.8	B (White zinc coating)	KG
1102080080B88D931K	M8	80	5.3	13.0	22	8.8	B (White zinc coating)	KG
1102080075B58D931K	M8	75	5.3	13.0	22	5.8	B (White zinc coating)	KG
1102080070B88D931K	M8	70	5.3	13.0	22	8.8	B (White zinc coating)	KG
1102080080B58D931K	M8	80	5.3	13.0	22	5.8	B (White zinc coating)	KG
1102080110B88D931T	M8	110	5.3	13.0	22	8.8	B (White zinc coating)	THS.
1102080090B88D931K	M8	90	5.3	13.0	22	8.8	B (White zinc coating)	KG
1102080045B58D931K	M8	45	5.3	13.0	22	5.8	B (White zinc coating)	KG
1102080090B58D931K	M8	90	5.3	13.0	22	5.8	B (White zinc coating)	KG
1102080070B58D931K	M8	70	5.3	13.0	22	5.8	B (White zinc coating)	KG
1102080140S10D931T	M8	140	5.3	13.0	22	10.9	S (raw product)	THS.
1102080120S10D931T	M8	120	5.3	13.0	26	10.9	S (raw product)	THS.
1102080120B58D931K	M8	120	5.3	13.0	22	5.8	B (White zinc coating)	KG
1102080140B58D931K	M8	140	5.3	13.0	22	5.8	B (White zinc coating)	KG
1102080050S10D931T	M8	50	5.3	13.0	22	10.9	S (raw product)	THS.
1102080070S10D931S	M8	70	5.3	13.0	22	10.9	S (raw product)	PCS.
1102080120B88D931K	M8	120	5.3	13.0	22	8.8	B (White zinc coating)	KG
1102080060S10D931T	M8	60	5.3	13.0	22	10.9	S (raw product)	THS.
1102080100S10D931T	M8	100	5.3	13.0	22	10.9	S (raw product)	THS.
1102080040S10D931T	M8	40	5.3	13.0	22	10.9	S (raw product)	THS.
1102060090B58D931K	M6	90	4.0	10.0	18	5.8	B (White zinc coating)	KG
1102060070B58D931K	M6	70	4.0	10.0	18	5.8	B (White zinc coating)	KG
1102060080B88D931T	M6	80	4.0	10.0	18	8.8	B (White zinc coating)	THS.
1102060060B88D931K	M6	60	4.0	10.0	18	8.8	B (White zinc coating)	KG
1102060040B58D931K	M6	40	4.0	10.0	18	5.8	B (White zinc coating)	KG
1102060050B88D931K	M6	50	4.0	10.0	18	8.8	B (White zinc coating)	KG
1102060070B88D931T	M6	70	4.0	10.0	18	8.8	B (White zinc coating)	THS.
1102060120B88D931K	M6	120	4.0	10.0	18	8.8	B (White zinc coating)	KG
1102060060B58D931K	M6	60	4.0	10.0	18	5.8	B (White zinc coating)	KG
1102060045B88D931K	M6	45	4.0	10.0	18	8.8	B (White zinc coating)	KG
1102060100B58D931K	M6	100	4.0	10.0	18	5.8	B (White zinc coating)	KG
1102060100B88D931T	M6	100	4.0	10.0	18	8.8	B (White zinc coating)	THS.
1102060050B58D931K	M6	50	4.0	10.0	18	5.8	B (White zinc coating)	KG