

11.01
S6K

Hexagonal head bolt, fully threaded

SEND THE INQUIRY

+48 58 55 40 410



Standards:

DIN 933
GOST 7798-70
ISO 4017
PN-M 82105

5.8 **8.8** **10.9**

Class (standard):

12.9

Class (special order):

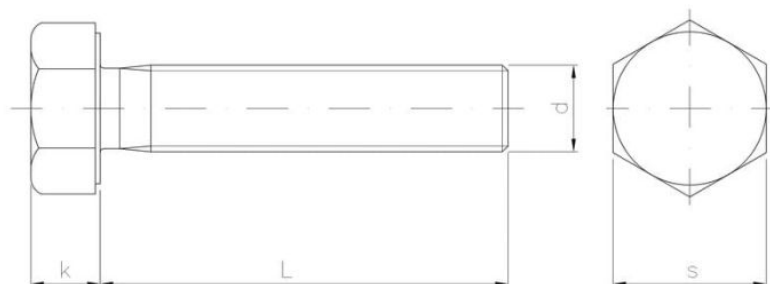

Coating (standard):

B
WHITE
ZINC
COATING

A **C** **G**
YELLOW BLACK HDG
ZINC ZINC
COATING COATING

Coating (special order):

N
NICKEL
COATING



Dimensions

Material index	d	L [mm]	k [mm]	s [mm]	Mechanical properties class	Type of coating	Measure unit
1101050010B58D933K	M5	10	3.5	8.0	5.8	B (White zinc coating)	KG
1101050010B88D933K	M5	10	3.5	8.0	8.8	B (White zinc coating)	KG
1101050012B58D933K	M5	12	3.5	8.0	5.8	B (White zinc coating)	KG
1101050012B88D933K	M5	12	3.5	8.0	8.8	B (White zinc coating)	KG
1101050016B58D933K	M5	16	3.5	8.0	5.8	B (White zinc coating)	KG
1101050016B88D933K	M5	16	3.5	8.0	8.8	B (White zinc coating)	KG
1101050020B58D933K	M5	20	3.5	8.0	5.8	B (White zinc coating)	KG
1101050020B88D933K	M5	20	3.5	8.0	8.8	B (White zinc coating)	KG
1101050025B58D933K	M5	25	3.5	8.0	5.8	B (White zinc coating)	KG
1101050025B88D933K	M5	25	3.5	8.0	8.8	B (White zinc coating)	KG
1101050030B58D933K	M5	30	3.5	8.0	5.8	B (White zinc coating)	KG
1101050030B88D933K	M5	30	3.5	8.0	8.8	B (White zinc coating)	KG
1101050030B88D933T	M5	30	3.5	8.0	8.8	B (White zinc coating)	THS.
1101050035B58D933K	M5	35	3.5	8.0	5.8	B (White zinc coating)	KG
1101050035B88D933K	M5	35	3.5	8.0	8.8	B (White zinc coating)	KG
1101050040B58D933K	M5	40	3.5	8.0	5.8	B (White zinc coating)	KG

Material index	d	L [mm]	k [mm]	s [mm]	Mechanical properties class	Type of coating	Measure unit
1101050040B88D933K	M5	40	3.5	8.0	8.8	B (White zinc coating)	KG
1101050050B58D933K	M5	50	3.5	8.0	5.8	B (White zinc coating)	KG
1101050050B88D933K	M5	50	3.5	8.0	8.8	B (White zinc coating)	KG
1101050060B88D933T	M5	60	3.5	8.0	8.8	B (White zinc coating)	THS.
1101060010B58D933K	M6	10	4.0	10.0	5.8	B (White zinc coating)	KG
1101060010B88D933K	M6	10	4.0	10.0	8.8	B (White zinc coating)	KG
1101060012B58D933K	M6	12	4.0	10.0	5.8	B (White zinc coating)	KG
1101060012B88D933K	M6	12	4.0	10.0	8.8	B (White zinc coating)	KG
1101060012B88D933T	M6	12	4.0	10.0	8.8	B (White zinc coating)	THS.
1101060016B58D933K	M6	16	4.0	10.0	5.8	B (White zinc coating)	KG
1101060016B88D933K	M6	16	4.0	10.0	8.8	B (White zinc coating)	KG
1101060016B88D933T	M6	16	4.0	10.0	8.8	B (White zinc coating)	THS.
1101060020B58D933K	M6	20	4.0	10.0	5.8	B (White zinc coating)	KG
1101060020B88D933K	M6	20	4.0	10.0	8.8	B (White zinc coating)	KG
1101060020B88D933T	M6	20	4.0	10.0	8.8	B (White zinc coating)	THS.
1101060020S10D933T	M6	20	4.0	10.0	10.9	S (raw product)	THS.
1101060025B58D933K	M6	25	4.0	10.0	5.8	B (White zinc coating)	KG
1101060025B88D933K	M6	25	4.0	10.0	8.8	B (White zinc coating)	KG
1101060025B88D933T	M6	25	4.0	10.0	8.8	B (White zinc coating)	THS.
1101060025S10D933T	M6	25	4.0	10.0	10.9	S (raw product)	THS.
1101060030B58D933K	M6	30	4.0	10.0	5.8	B (White zinc coating)	KG
1101060030B88D933K	M6	30	4.0	10.0	8.8	B (White zinc coating)	KG
1101060030B88D933T	M6	30	4.0	10.0	8.8	B (White zinc coating)	THS.
1101060030S10D933T	M6	30	4.0	10.0	10.9	S (raw product)	THS.
1101060035B58D933K	M6	35	4.0	10.0	5.8	B (White zinc coating)	KG
1101060035B88D933K	M6	35	4.0	10.0	8.8	B (White zinc coating)	KG
1101060035B88D933T	M6	35	4.0	10.0	8.8	B (White zinc coating)	THS.
1101060040B58D933K	M6	40	4.0	10.0	5.8	B (White zinc coating)	KG
1101060040B88D933K	M6	40	4.0	10.0	8.8	B (White zinc coating)	KG
1101060040B88D933T	M6	40	4.0	10.0	8.8	B (White zinc coating)	THS.
1101060040S10D933T	M6	40	4.0	10.0	10.9	S (raw product)	THS.
1101060045B58D933K	M6	45	4.0	10.0	5.8	B (White zinc coating)	KG
1101060045B88D933K	M6	45	4.0	10.0	8.8	B (White zinc coating)	KG
1101060050B58D933K	M6	50	4.0	10.0	5.8	B (White zinc coating)	KG
1101060050B88D933K	M6	50	4.0	10.0	8.8	B (White zinc coating)	KG
1101060050B88D933T	M6	50	4.0	10.0	8.8	B (White zinc coating)	THS.
1101060055B58D933K	M6	55	4.0	10.0	5.8	B (White zinc coating)	KG
1101060055B88D933K	M6	60	4.0	10.0	8.8	B (White zinc coating)	KG
1101060060B58D933K	M6	60	4.0	10.0	5.8	B (White zinc coating)	KG

Material index	d	L [mm]	k [mm]	s [mm]	Mechanical properties class	Type of coating	Measure unit
1101060060B88D933K	M6	60	4.0	10.0	8.8	B (White zinc coating)	KG
1101060060B88D933T	M6	60	4.0	10.0	8.8	B (White zinc coating)	THS.
1101060065B88D933T	M6	65	4.0	10.0	8.8	B (White zinc coating)	THS.
1101060070B58D933K	M6	70	4.0	10.0	5.8	B (White zinc coating)	KG
1101060070B88D933K	M6	70	4.0	10.0	8.8	B (White zinc coating)	KG
1101060080B58D933K	M6	80	4.0	10.0	5.8	B (White zinc coating)	KG
1101060080B88D933K	M6	80	4.0	10.0	8.8	B (White zinc coating)	KG
1101060080B88D933T	M6	80	4.0	10.0	8.8	B (White zinc coating)	THS.
1101060090B58D933K	M6	90	4.0	10.0	5.8	B (White zinc coating)	KG
1101060090B88D933K	M6	90	4.0	10.0	8.8	B (White zinc coating)	KG
1101060100B58D933K	M6	100	4.0	10.0	5.8	B (White zinc coating)	KG
1101060100B88D933K	M6	100	4.0	10.0	8.8	B (White zinc coating)	KG
1101060120B58D933K	M6	120	4.0	10.0	5.8	B (White zinc coating)	KG
1101060120B88D933K	M6	120	4.0	10.0	8.8	B (White zinc coating)	KG
1101080010B88D933T	M8	10	5.3	13.0	8.8	B (White zinc coating)	THS.
1101080012B58D933K	M8	12	5.3	13.0	5.8	B (White zinc coating)	KG
1101080012B88D933K	M8	12	5.3	13.0	8.8	B (White zinc coating)	KG
1101080012B88D933T	M8	12	5.3	13.0	8.8	B (White zinc coating)	THS.
1101080016B58D933K	M8	16	5.3	13.0	5.8	B (White zinc coating)	KG
1101080016B88D933K	M8	16	5.3	13.0	8.8	B (White zinc coating)	KG
1101080016B88D933T	M8	14	5.3	13.0	8.8	B (White zinc coating)	THS.
1101080020B58D933K	M8	20	5.3	13.0	5.8	B (White zinc coating)	KG
1101080020B88D933K	M8	20	5.3	13.0	8.8	B (White zinc coating)	KG
1101080020B88D933T	M8	20	5.3	13.0	8.8	B (White zinc coating)	THS.
1101080020S10D933T	M8	20	5.3	13.0	10.9	S (raw product)	THS.
1101080025B58D933K	M8	25	5.3	13.0	5.8	B (White zinc coating)	KG
1101080025B88D933K	M8	25	5.3	13.0	8.8	B (White zinc coating)	KG
1101080025B88D933T	M8	25	5.3	13.0	8.8	B (White zinc coating)	THS.
1101080025S10D933T	M8	25	5.3	13.0	10.9	S (raw product)	THS.
1101080030B58D933K	M8	30	5.3	13.0	5.8	B (White zinc coating)	KG
1101080030B88D933K	M8	30	5.3	13.0	8.8	B (White zinc coating)	KG
1101080030B88D933T	M8	30	5.3	13.0	8.8	B (White zinc coating)	THS.
1101080030S10D933T	M8	30	5.3	13.0	10.9	S (raw product)	THS.
1101080035B58D933K	M8	35	5.3	13.0	5.8	B (White zinc coating)	KG
1101080035B88D933K	M8	35	5.3	13.0	8.8	B (White zinc coating)	KG
1101080035B88D933T	M8	35	5.3	13.0	8.8	B (White zinc coating)	THS.
1101080035S10D933T	M8	35	5.3	13.0	10.9	S (raw product)	THS.
1101080040B58D933K	M8	40	5.3	13.0	5.8	B (White zinc coating)	KG
1101080040B88D933K	M8	40	5.3	13.0	8.8	B (White zinc coating)	KG

Material index	d	L [mm]	k [mm]	s [mm]	Mechanical properties class	Type of coating	Measure unit
1101080040B88D933T	M8	40	5.3	13.0	8.8	B (White zinc coating)	THS.
1101080040S10D933T	M8	40	5.3	13.0	10.9	S (raw product)	THS.
1101080045B58D933K	M8	45	5.3	13.0	5.8	B (White zinc coating)	KG
1101080045B88D933K	M8	45	5.3	13.0	8.8	B (White zinc coating)	KG
1101080045B88D933T	M8	45	5.3	13.0	8.8	B (White zinc coating)	THS.
1101080045S10D933T	M8	45	5.3	13.0	10.9	S (raw product)	THS.
1101080050B58D933K	M8	50	5.3	13.0	5.8	B (White zinc coating)	KG
1101080050B58D933T	M8	50	5.3	13.0	5.8	B (White zinc coating)	THS.
1101080050B88D933K	M8	50	5.3	13.0	8.8	B (White zinc coating)	KG
1101080050B88D933T	M8	50	5.3	13.0	8.8	B (White zinc coating)	THS.
1101080050S10D933T	M8	50	5.3	13.0	10.9	S (raw product)	THS.
1101080055B58D933K	M8	55	5.3	13.0	5.8	B (White zinc coating)	KG
1101080055B88D933K	M8	55	5.3	13.0	8.8	B (White zinc coating)	KG
1101080060B58D933K	M8	60	5.3	13.0	5.8	B (White zinc coating)	KG
1101080060B58D933T	M8	60	5.3	13.0	5.8	B (White zinc coating)	THS.
1101080060B88D933K	M8	60	5.3	13.0	8.8	B (White zinc coating)	KG
1101080060B88D933T	M8	60	5.3	13.0	8.8	B (White zinc coating)	THS.
1101080060S10D933T	M8	60	5.3	13.0	10.9	S (raw product)	THS.
1101080070B58D933K	M8	70	5.3	13.0	5.8	B (White zinc coating)	KG
1101080070B88D933K	M8	70	5.3	13.0	8.8	B (White zinc coating)	KG
1101080070B88D933T	M8	70	5.3	13.0	8.8	B (White zinc coating)	THS.
1101080070S10D933T	M8	70	5.3	13.0	10.9	S (raw product)	THS.
1101080080B58D933K	M8	80	5.3	13.0	5.8	B (White zinc coating)	KG
1101080080B88D933K	M8	80	5.3	13.0	8.8	B (White zinc coating)	KG
1101080080B88D933T	M8	80	5.3	13.0	8.8	B (White zinc coating)	THS.
1101080080S10D933T	M8	80	5.3	13.0	10.9	S (raw product)	THS.
1101080090B58D933K	M8	90	5.3	16.0	5.8	B (White zinc coating)	KG
1101080090B88D933K	M8	90	5.3	13.0	8.8	B (White zinc coating)	KG
1101080090B88D933T	M8	90	5.3	13.0	8.8	B (White zinc coating)	THS.
1101080090S10D933T	M8	90	5.3	13.0	10.9	S (raw product)	THS.
1101080100B58D933K	M8	100	5.3	13.0	5.8	B (White zinc coating)	KG
1101080100B88D933K	M8	100	5.3	13.0	8.8	B (White zinc coating)	KG
1101080100B88D933T	M8	100	5.3	13.0	8.8	B (White zinc coating)	THS.
1101080100S10D933T	M8	100	5.3	13.0	10.9	S (raw product)	THS.
1101080120B88D933T	M8	120	5.3	13.0	8.8	B (White zinc coating)	THS.
1101100016B58D933K	M10	16	6.4	17.0	5.8	B (White zinc coating)	KG
1101100016B88D933K	M10	16	6.4	17.0	8.8	B (White zinc coating)	KG
1101100020B58D933K	M10	20	6.4	17.0	5.8	B (White zinc coating)	KG
1101100020B88D933K	M10	20	6.4	17.0	8.8	B (White zinc coating)	KG

Material index	d	L [mm]	k [mm]	s [mm]	Mechanical properties class	Type of coating	Measure unit
1101100020B88D933T	M10	20	6.4	17.0	8.8	B (White zinc coating)	THS.
1101100020S10D933T	M10	20	6.4	17.0	10.9	S (raw product)	THS.
1101100025B58D933K	M10	25	6.4	17.0	5.8	B (White zinc coating)	KG
1101100025B88D933K	M10	25	6.4	17.0	8.8	B (White zinc coating)	KG
1101100025B88D933T	M10	25	6.4	17.0	8.8	B (White zinc coating)	THS.
1101100025S10D933T	M10	25	6.4	17.0	10.9	S (raw product)	THS.
1101100030B58D933K	M10	30	6.4	17.0	5.8	B (White zinc coating)	KG
1101100030B88D933K	M10	30	6.4	17.0	8.8	B (White zinc coating)	KG
1101100030B88D933T	M10	30	6.4	17.0	8.8	B (White zinc coating)	THS.
1101100030S10D933T	M10	30	6.4	17.0	10.9	S (raw product)	THS.
1101100035B58D933K	M10	35	6.4	17.0	5.8	B (White zinc coating)	KG
1101100035B88D933K	M10	35	6.4	17.0	8.8	B (White zinc coating)	KG
1101100035B88D933T	M10	35	6.4	17.0	8.8	B (White zinc coating)	THS.
1101100035S10D933S	M10	35	6.4	17.0	10.9	S (raw product)	PCS.
1101100040B58D933K	M10	40	6.4	17.0	5.8	B (White zinc coating)	KG
1101100040B88D933K	M10	40	6.4	17.0	8.8	B (White zinc coating)	KG
1101100040B88D933T	M10	40	6.4	17.0	8.8	B (White zinc coating)	THS.
1101100040S10D933T	M10	40	6.4	17.0	10.9	S (raw product)	THS.
1101100045B58D933K	M10	45	6.4	17.0	5.8	B (White zinc coating)	KG
1101100045B88D933K	M10	45	6.4	17.0	8.8	B (White zinc coating)	KG
1101100045B88D933T	M10	45	6.4	17.0	8.8	B (White zinc coating)	THS.
1101100045S10D933T	M10	45	6.4	17.0	10.9	S (raw product)	THS.
1101100050B58D933K	M10	50	6.4	17.0	5.8	B (White zinc coating)	KG
1101100050B88D933K	M10	50	6.4	17.0	8.8	B (White zinc coating)	KG
1101100050B88D933T	M10	50	6.4	17.0	8.8	B (White zinc coating)	THS.
1101100050S10D933T	M10	50	6.4	17.0	10.9	S (raw product)	THS.
1101100060B58D933K	M10	60	6.4	17.0	5.8	B (White zinc coating)	KG
1101100060B88D933K	M10	60	6.4	17.0	8.8	B (White zinc coating)	KG
1101100060B88D933T	M10	60	6.4	17.0	8.8	B (White zinc coating)	THS.
1101100060S10D933T	M10	60	6.4	17.0	10.9	S (raw product)	THS.
1101100065B88D933K	M10	65	6.4	17.0	8.8	B (White zinc coating)	KG
1101100065C88D933K	M10	65	6.4	17.0	8.8	C (black zinc coating)	KG
1101100070B58D933K	M10	70	6.4	17.0	5.8	B (White zinc coating)	KG
1101100070B88D933K	M10	70	6.4	17.0	8.8	B (White zinc coating)	KG
1101100070B88D933T	M10	70	6.4	17.0	8.8	B (White zinc coating)	THS.
1101100070S10D933T	M10	70	6.4	17.0	10.9	S (raw product)	THS.
1101100080B58D933K	M10	80	6.4	17.0	5.8	B (White zinc coating)	KG
1101100080B88D933K	M10	80	6.4	17.0	8.8	B (White zinc coating)	KG
1101100080B88D933T	M10	80	6.4	17.0	8.8	B (White zinc coating)	THS.

Material index	d	L [mm]	k [mm]	s [mm]	Mechanical properties class	Type of coating	Measure unit
1101100080S10D933T	M10	80	6.4	17.0	10.9	S (raw product)	THS.
1101100090B58D933K	M10	90	6.4	17.0	5.8	B (White zinc coating)	KG
1101100090B88D933K	M10	90	6.4	17.0	8.8	B (White zinc coating)	KG
1101100090S10D933T	M10	90	6.4	17.0	10.9	S (raw product)	THS.
1101100100B58D933K	M10	100	6.4	17.0	5.8	B (White zinc coating)	KG
1101100100B88D933K	M10	100	6.4	17.0	8.8	B (White zinc coating)	KG
1101100100B88D933T	M10	100	6.4	17.0	8.8	B (White zinc coating)	THS.
1101100100S10D933T	M10	100	6.4	17.0	10.9	S (raw product)	THS.
1101100120B58D933K	M10	120	6.4	17.0	5.8	B (White zinc coating)	KG
1101100120B88D933K	M10	120	6.4	17.0	8.8	B (White zinc coating)	KG
1101100120B88D933S	M10	120	6.4	17.0	8.8	B (White zinc coating)	PCS.
1101120020B58D933K	M12	20	7.5	19.0	5.8	B (White zinc coating)	KG
1101120020B88D933K	M12	20	7.5	19.0	8.8	B (White zinc coating)	KG
1101120020S10D933T	M12	20	7.5	19.0	10.9	S (raw product)	THS.
1101120025B58D933K	M12	25	7.5	19.0	5.8	B (White zinc coating)	KG
1101120025B88D933K	M12	25	7.5	19.0	8.8	B (White zinc coating)	KG
1101120025B88D933T	M12	25	7.5	19.0	8.8	B (White zinc coating)	THS.
1101120025S10D933T	M12	25	7.5	19.0	10.9	S (raw product)	THS.
1101120030B58D933K	M12	30	7.5	19.0	5.8	B (White zinc coating)	KG
1101120030B88D933K	M12	30	7.5	19.0	8.8	B (White zinc coating)	KG
1101120030B88D933T	M12	30	7.5	19.0	8.8	B (White zinc coating)	THS.
1101120030S10D933T	M12	30	7.5	19.0	10.9	S (raw product)	THS.
1101120035B10D933T	M12	35	7.5	19.0	10.9	S (raw product)	THS.
1101120035B58D933K	M12	35	7.5	19.0	5.8	B (White zinc coating)	KG
1101120035B88D933K	M12	35	7.5	19.0	8.8	B (White zinc coating)	KG
1101120035B88D933T	M12	35	7.5	19.0	8.8	B (White zinc coating)	THS.
1101120035S10D933T	M12	35	7.5	19.0	10.9	S (raw product)	THS.
1101120040B58D933K	M12	40	7.5	19.0	5.8	B (White zinc coating)	KG
1101120040B88D933K	M12	40	7.5	19.0	8.8	B (White zinc coating)	KG
1101120040B88D933T	M12	40	7.5	19.0	8.8	B (White zinc coating)	THS.
1101120040S10D933T	M12	40	7.5	19.0	10.9	S (raw product)	THS.
1101120045B58D933K	M12	45	7.5	19.0	5.8	B (White zinc coating)	KG
1101120045B88D933K	M12	45	7.5	19.0	8.8	B (White zinc coating)	KG
1101120045B88D933T	M12	45	7.5	19.0	8.8	B (White zinc coating)	THS.
1101120045S10D933T	M12	45	7.5	19.0	10.9	S (raw product)	THS.
1101120050B58D933K	M12	50	7.5	19.0	5.8	B (White zinc coating)	KG
1101120050B88D933K	M12	50	7.5	19.0	8.8	B (White zinc coating)	KG
1101120050B88D933T	M12	50	7.5	19.0	8.8	B (White zinc coating)	THS.
1101120050S10D933S	M12	50	7.5	19.0	10.9	S (raw product)	PCS.

Material index	d	L [mm]	k [mm]	s [mm]	Mechanical properties class	Type of coating	Measure unit
1101120055B58D933K	M12	55	7.5	19.0	5.8	B (White zinc coating)	KG
1101120055B88D933K	M12	55	7.5	19.0	8.8	B (White zinc coating)	KG
1101120055B88D933T	M12	55	7.5	19.0	8.8	B (White zinc coating)	THS.
1101120060B58D933K	M12	60	7.5	19.0	5.8	B (White zinc coating)	KG
1101120060B88D933K	M12	60	7.5	19.0	8.8	B (White zinc coating)	KG
1101120060B88D933T	M12	60	7.5	19.0	8.8	B (White zinc coating)	THS.
1101120060S10D933T	M12	60	7.5	19.0	10.9	S (raw product)	THS.
1101120065B58D933K	M12	65	7.5	19.0	5.8	B (White zinc coating)	KG
1101120065B88D933K	M12	65	7.5	19.0	8.8	B (White zinc coating)	KG
1101120070B58D933K	M12	70	7.5	19.0	5.8	B (White zinc coating)	KG
1101120070B88D933K	M12	70	7.5	19.0	8.8	B (White zinc coating)	KG
1101120070B88D933T	M12	70	7.5	19.0	8.8	B (White zinc coating)	THS.
1101120070S10D933S	M12	70	7.5	19.0	10.9	S (raw product)	PCS.
1101120080B58D933K	M12	80	7.5	19.0	5.8	B (White zinc coating)	KG
1101120080B88D933K	M12	80	7.5	19.0	8.8	B (White zinc coating)	KG
1101120080B88D933T	M12	80	7.5	19.0	8.8	B (White zinc coating)	THS.
1101120080S10D933T	M12	80	7.5	19.0	10.9	S (raw product)	THS.
1101120090B58D933K	M12	90	7.5	19.0	5.8	B (White zinc coating)	KG
1101120090B88D933K	M12	90	7.5	19.0	8.8	B (White zinc coating)	KG
1101120090B88D933T	M12	90	7.5	19.0	8.8	B (White zinc coating)	THS.
1101120090S10D933S	M12	90	7.5	19.0	10.9	S (raw product)	PCS.
1101120100B58D933K	M12	100	7.5	19.0	5.8	B (White zinc coating)	KG
1101120100B88D933K	M12	100	7.5	19.0	8.8	B (White zinc coating)	KG
1101120100B88D933T	M12	100	7.5	19.0	8.8	B (White zinc coating)	THS.
1101120100S10D933S	M12	100	7.5	19.0	10.9	S (raw product)	PCS.
1101120120B88D933K	M12	120	7.5	19.0	8.8	B (White zinc coating)	KG
1101120120B88D933T	M12	120	7.5	19.0	8.8	B (White zinc coating)	THS.
1101140030B58D933K	M14	30	9.0	22.0	5.8	B (White zinc coating)	KG
1101140030B88D933K	M14	30	9.0	22.0	8.8	B (White zinc coating)	KG
1101140030S10D933T	M14	30	9.0	22.0	10.9	S (raw product)	THS.
1101140035B88D933K	M14	35	9.0	22.0	8.8	B (White zinc coating)	KG
1101140040B58D933K	M14	40	9.0	22.0	5.8	B (White zinc coating)	KG
1101140040B88D933K	M14	40	9.0	22.0	8.8	B (White zinc coating)	KG
1101140040S10D933T	M14	40	9.0	22.0	10.9	S (raw product)	THS.
1101140045B88D933K	M14	45	9.0	22.0	8.8	B (White zinc coating)	KG
1101140050B58D933K	M14	50	9.0	22.0	5.8	B (White zinc coating)	KG
1101140050B88D933K	M14	30	9.0	22.0	8.8	B (White zinc coating)	KG
1101140050B88D933T	M14	50	9.0	22.0	8.8	B (White zinc coating)	THS.
1101140050S10D933S	M14	50	9.0	22.0	10.9	S (raw product)	PCS.

Material index	d	L [mm]	k [mm]	s [mm]	Mechanical properties class	Type of coating	Measure unit
1101140060B88D933K	M14	60	9.0	22.0	8.8	B (White zinc coating)	KG
1101140060B88D933S	M14	60	9.0	22.0	8.8	B (White zinc coating)	PCS.
1101140060S10D933S	M14	60	9.0	22.0	10.9	S (raw product)	PCS.
1101140070B88D933K	M14	70	9.0	22.0	8.8	B (White zinc coating)	KG
1101140070B88D933S	M14	70	9.0	22.0	8.8	B (White zinc coating)	PCS.
1101140070S10D933S	M14	70	9.0	22.0	10.9	S (raw product)	PCS.
1101140080B88D933K	M14	40	9.0	22.0	8.8	B (White zinc coating)	KG
1101140080S10D933S	M14	80	9.0	22.0	10.9	S (raw product)	PCS.
1101160025B58D933K	M16	25	10.0	24.0	5.8	B (White zinc coating)	KG
1101160025B88D933K	M16	25	10.0	24.0	8.8	B (White zinc coating)	KG
1101160030B58D933K	M16	30	10.0	24.0	5.8	B (White zinc coating)	KG
1101160030B88D933K	M16	30	10.0	24.0	8.8	B (White zinc coating)	KG
1101160030B88D933T	M16	30	10.0	24.0	8.8	B (White zinc coating)	THS.
1101160030S10D933S	M16	30	10.0	24.0	10.9	S (raw product)	PCS.
1101160035B58D933K	M16	35	10.0	24.0	5.8	B (White zinc coating)	KG
1101160035B88D933K	M16	35	10.0	24.0	8.8	B (White zinc coating)	KG
1101160035B88D933T	M16	35	10.0	24.0	8.8	B (White zinc coating)	THS.
1101160035S10D933S	M16	35	10.0	24.0	10.9	S (raw product)	PCS.
1101160040B58D933K	M16	40	10.0	24.0	5.8	B (White zinc coating)	KG
1101160040B88D933K	M16	40	10.0	24.0	8.8	B (White zinc coating)	KG
1101160040B88D933T	M16	40	10.0	24.0	8.8	B (White zinc coating)	THS.
1101160040S10D933S	M16	40	10.0	24.0	10.9	S (raw product)	PCS.
1101160045B58D933K	M16	45	10.0	24.0	5.8	B (White zinc coating)	KG
1101160045B88D933K	M16	45	10.0	24.0	8.8	B (White zinc coating)	KG
1101160045B88D933T	M16	45	10.0	24.0	8.8	B (White zinc coating)	THS.
1101160045S10D933S	M16	45	10.0	24.0	10.9	S (raw product)	PCS.
1101160050B58D933K	M16	50	10.0	24.0	5.8	B (White zinc coating)	KG
1101160050B88D933K	M16	50	10.0	24.0	8.8	B (White zinc coating)	KG
1101160050B88D933T	M16	50	10.0	24.0	8.8	B (White zinc coating)	THS.
1101160050S10D933S	M16	50	10.0	24.0	10.9	S (raw product)	PCS.
1101160055B88D933K	M16	55	10.0	24.0	8.8	B (White zinc coating)	KG
1101160055B88D933T	M16	55	10.0	24.0	8.8	B (White zinc coating)	THS.
1101160060B58D933K	M16	60	10.0	24.0	5.8	B (White zinc coating)	KG
1101160060B88D933K	M16	60	10.0	24.0	8.8	B (White zinc coating)	KG
1101160060B88D933T	M16	60	10.0	24.0	8.8	B (White zinc coating)	THS.
1101160060S10D933S	M16	60	10.0	24.0	10.9	S (raw product)	PCS.
1101160065B58D933K	M16	65	10.0	24.0	5.8	B (White zinc coating)	KG
1101160065B88D933K	M16	65	10.0	24.0	8.8	B (White zinc coating)	KG
1101160065B88D933T	M16	65	10.0	24.0	8.8	B (White zinc coating)	THS.

Material index	d	L [mm]	k [mm]	s [mm]	Mechanical properties class	Type of coating	Measure unit
1101160070B58D933K	M16	70	10.0	24.0	5.8	B (White zinc coating)	KG
1101160070B88D933K	M16	70	10.0	24.0	8.8	B (White zinc coating)	KG
1101160070B88D933T	M16	70	10.0	24.0	8.8	B (White zinc coating)	THS.
1101160070S10D933S	M16	70	10.0	24.0	10.9	S (raw product)	PCS.
1101160080B58D933K	M16	80	10.0	24.0	5.8	B (White zinc coating)	KG
1101160080B88D933K	M16	80	10.0	24.0	8.8	B (White zinc coating)	KG
1101160080B88D933T	M16	80	10.0	24.0	8.8	B (White zinc coating)	THS.
1101160080S10D933S	M16	80	10.0	24.0	10.9	S (raw product)	PCS.
1101160090B58D933K	M16	90	10.0	24.0	5.8	B (White zinc coating)	KG
1101160090B88D933K	M16	90	10.0	24.0	8.8	B (White zinc coating)	KG
1101160090S10D933S	M16	90	10.0	24.0	10.9	S (raw product)	PCS.
1101160100B58D933K	M16	100	10.0	24.0	5.8	B (White zinc coating)	KG
1101160100B88D933K	M16	100	10.0	24.0	8.8	B (White zinc coating)	KG
1101160100B88D933T	M16	100	10.0	24.0	8.8	B (White zinc coating)	THS.
1101160100S10D933S	M16	100	10.0	24.0	10.9	S (raw product)	PCS.
1101160120B58D933K	M16	120	10.0	24.0	8.8	B (White zinc coating)	KG
1101160120B88D933K	M16	120	10.0	24.0	8.8	B (White zinc coating)	KG
1101180050B88D933S	M18	50	12.0	27.0	8.8	B (White zinc coating)	PCS.
1101180050S10D933S	M18	50	12.0	27.0	10.9	S (raw product)	PCS.
1101180060B88D933S	M18	60	12.0	27.0	8.8	B (White zinc coating)	PCS.
1101180060S10D933S	M18	60	12.0	27.0	10.9	S (raw product)	PCS.
1101180070S10D933S	M18	70	12.0	27.0	10.9	S (raw product)	PCS.
1101180080B88D933S	M18	80	12.0	27.0	8.8	B (White zinc coating)	PCS.
1101180080S10D933S	M18	80	12.0	27.0	10.9	S (raw product)	PCS.
1101200040B58D933K	M20	40	12.5	30.0	5.8	B (White zinc coating)	KG
1101200040B88D933K	M20	40	12.5	30.0	8.8	B (White zinc coating)	KG
1101200040S10D933S	M20	40	12.5	30.0	10.9	S (raw product)	PCS.
1101200045B88D933K	M20	45	12.5	30.0	8.8	B (White zinc coating)	KG
1101200050B58D933K	M20	50	12.5	30.0	5.8	B (White zinc coating)	KG
1101200050B88D933K	M20	50	12.5	30.0	8.8	B (White zinc coating)	KG
1101200050B88D933S	M20	50	12.5	30.0	8.8	B (White zinc coating)	PCS.
1101200050S10D933S	M20	50	12.5	30.0	10.9	S (raw product)	PCS.
1101200055B88D933K	M20	55	12.5	30.0	8.8	B (White zinc coating)	KG
1101200060B58D933K	M20	60	12.5	30.0	5.8	B (White zinc coating)	KG
1101200060B88D933K	M20	60	12.5	30.0	8.8	B (White zinc coating)	KG
1101200060B88D933S	M20	60	12.5	30.0	8.8	B (White zinc coating)	PCS.
1101200060S10D933S	M20	60	12.5	30.0	10.9	S (raw product)	PCS.
1101200065B88D933S	M20	65	12.5	30.0	8.8	B (White zinc coating)	PCS.
1101200070B58D933K	M20	70	12.5	30.0	5.8	B (White zinc coating)	KG

Material index	d	L [mm]	k [mm]	s [mm]	Mechanical properties class	Type of coating	Measure unit
1101200070B88D933K	M20	70	12.5	30.0	8.8	B (White zinc coating)	KG
1101200070B88D933S	M20	70	12.5	30.0	8.8	B (White zinc coating)	PCS.
1101200070S10D933S	M20	70	12.5	30.0	10.9	S (raw product)	PCS.
1101200080B58D933K	M20	80	12.5	30.0	5.8	B (White zinc coating)	KG
1101200080B88D933K	M20	80	12.5	30.0	8.8	B (White zinc coating)	KG
1101200080B88D933S	M20	80	12.5	30.0	8.8	B (White zinc coating)	PCS.
1101200080S10D933S	M20	80	12.5	30.0	10.9	S (raw product)	PCS.
1101200090B58D933K	M20	90	12.5	30.0	5.8	B (White zinc coating)	KG
1101200090B88D933K	M20	90	12.5	30.0	8.8	B (White zinc coating)	KG
1101200090S10D933S	M20	90	12.5	30.0	10.9	S (raw product)	PCS.
1101200100B58D933K	M20	100	12.5	30.0	5.8	B (White zinc coating)	KG
1101200100B88D933K	M20	100	12.5	30.0	8.8	B (White zinc coating)	KG
1101200100B88D933S	M20	100	12.5	30.0	8.8	B (White zinc coating)	PCS.
1101200100S10D933S	M20	100	12.5	30.0	10.9	S (raw product)	PCS.
1101200120B58D933K	M20	120	12.5	30.0	5.8	B (White zinc coating)	KG
1101200120B88D933K	M20	120	12.5	30.0	8.8	B (White zinc coating)	KG
1101240060B88D933S	M24	60	15.0	36.0	8.8	B (White zinc coating)	PCS.
1101240070B88D933S	M24	70	15.0	36.0	8.8	B (White zinc coating)	PCS.
1101240080B58D933K	M24	80	15.0	36.0	5.8	B (White zinc coating)	KG
1101240080B88D933K	M24	80	15.0	36.0	8.8	B (White zinc coating)	KG
1101240080B88D933S	M24	80	15.0	36.0	8.8	B (White zinc coating)	PCS.
1101240090B88D933K	M24	90	15.0	36.0	8.8	B (White zinc coating)	KG
1101240090B88D933S	M24	90	15.0	36.0	8.8	B (White zinc coating)	PCS.
1101240100B88D933K	M24	100	15.0	36.0	8.8	B (White zinc coating)	KG
1101240100B88D933S	M24	100	15.0	36.0	8.8	B (White zinc coating)	PCS.
1101240120B88D933S	M24	120	15.0	36.0	8.8	B (White zinc coating)	PCS.